

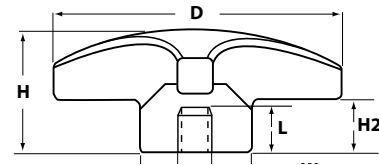

**4 Lobe Knob
Socket - Phenolic**

These best selling, economical phenolic 4 lobe female threaded (socket) knobs are offered with a brass threaded insert. They have highly polished smooth surfaces and do not show a parting line. Very sturdy and attractive for any industrial or commercial application.



4 LOBE KNOB WITH BRASS SOCKET - PHENOLIC

P/N	Dia.	Height	Width	H2	Thread	Length
IL262-4F	1-1/4	13/16	9/16	3/8	1/4-20	1/2
IL262-5F	1-1/4	13/16	9/16	3/8	5/16-18	1/2
IL262-6F	1-1/4	13/16	9/16	3/8	3/8-16	1/2
IL263-4F	2	1-1/4	29/32	19/32	1/4-20	1/2
IL263-5F	2	1-1/4	29/32	19/32	5/16-18	1/2
IL263-6F	2	1-1/4	29/32	19/32	3/8-16	1/2

**4 Lobe Knob
Steel Stud - Phenolic**

These best selling, economical phenolic 4 lobe threaded stud knobs are offered with a trivalent zinc plated steel stud. They have highly polished smooth surfaces and do not show a parting line. Very sturdy and attractive for any industrial or commercial application.

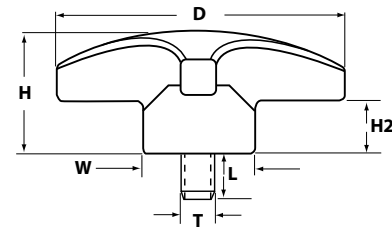

4 LOBE KNOB WITH STEEL STUD - PHENOLIC

P/N	Dia.	Height	Width	H2	Thread	Length
IL262-4MX1/2	1-1/4	13/16	9/16	3/8	1/4-20	1/2
IL262-4MX1	1-1/4	13/16	9/16	3/8	1/4-20	1
IL262-5MX1/2	1-1/4	13/16	9/16	3/8	5/16-18	1/2
IL262-5MX1	1-1/4	13/16	9/16	3/8	5/16-18	1
IL262-6MX3/4	1-1/4	13/16	9/16	3/8	3/8-16	3/4
IL262-6MX1	1-1/4	13/16	9/16	3/8	3/8-16	1
IL262-6MX1-1/2	1-1/4	13/16	9/16	3/8	3/8-16	1-1/2
IL263-4MX1	2	1-1/4	29/32	19/32	1/4-20	1
IL263-5MX1/2	2	1-1/4	29/32	19/32	5/16-18	1/2
IL263-5MX1	2	1-1/4	29/32	19/32	5/16-18	1
IL263-6MX3/4	2	1-1/4	29/32	19/32	3/8-16	3/4
IL263-6MX1	2	1-1/4	29/32	19/32	3/8-16	1
IL263-6MX1-1/2	2	1-1/4	29/32	19/32	3/8-16	1-1/2