

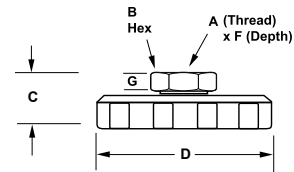

MEDIUM-DUTY LEVELERS
POLY SWIVEL
LOW PROFILE SOCKET

LOW PROFILE POLY SWIVEL SOCKET LEVELERS

The IEC Poly Base Steel and Stainless Steel Swivel Socket Leveler is ideal for medium-duty load requirements. Nylon bases 1" to 4" with 15 degree swivel from centerline. Steel Socket has trivalent zinc, yellow chromate finish.



Features

- Corrosion resistant
- 15 degree swivel
- 5 base diameters
- Glass-filled nylon
- Loads to 3,000 lbs.
- RoHS compliant

Applications

- Electronic equipment
- Enclosures
- Conveyors
- Machinery
- Work tables
- Display racks



Nut Height: "G" = 1/2", 5/8", 11/16", 3/4"
 for Threads: 1/2-13, 5/8-11, 3/4-10, 1-8

Nut Height: "G" = 3/16"
 for Threads: 1/4-20, 5/16-18, 3/8-18

LOW PROFILE POLY SWIVEL — SOCKET LEVELERS

Steel	Stainless	Load	A	B	C	D	F	G
IL51-4G	IL51-4S	100	1/4-20	1/2	5/8	1	3/8	3/16
IL51-5G	IL51-5S	500	5/16-18	1/2	5/8	1	3/8	3/16
IL51-6G	IL51-6S	1000	3/8-16	1/2	5/8	1	3/8	3/16
IL51-7G	IL51-7S	2000	1/2-13	5/8	15/16	1	3/8	1/2
IL51-8G	IL51-8S	3000	5/8-11	3/4	1-1/8	1	1/2	5/8
IL51-9G	IL51-9S	3000	3/4-10	1	1-3/16	1	9/16	11/16
IL51-10G	IL51-10S	3000	1-8	1-1/4	1-1/4	1	5/8	3/4
IL53-4G	IL53-4S	100	1/4-20	1/2	5/8	1 1/2	3/8	3/16
IL53-5G	IL53-5S	500	5/16-18	1/2	5/8	1 1/2	3/8	3/16
IL53-6G	IL53-6S	1000	3/8-16	1/2	5/8	1 1/2	3/8	3/16
IL53-7G	IL53-7S	2000	1/2-13	5/8	15/16	1 1/2	3/8	1/2
IL53-8G	IL53-8S	3000	5/8-11	3/4	1-1/8	1 1/2	1/2	5/8
IL53-9G	IL53-9S	3000	3/4-10	1	1-3/16	1 1/2	9/16	11/16
IL53-10G	IL53-10S	3000	1-8	1-1/4	1-1/4	1 1/2	5/8	3/4
IL55-4G	IL55-4S	100	1/4-20	1/2	5/8	2	3/8	3/16
IL55-5G	IL55-5S	500	5/16-18	1/2	5/8	2	3/8	3/16
IL55-6G	IL55-6S	1000	3/8-16	1/2	5/8	2	3/8	3/16
IL55-7G	IL55-7S	2000	1/2-13	5/8	15/16	2	3/8	1/2
IL55-8G	IL55-8S	3000	5/8-11	3/4	1-1/8	2	1/2	5/8
IL55-9G	IL55-9S	3000	3/4-10	1	1-3/16	2	9/16	11/16
IL55-10G	IL55-10S	3000	1-8	1-1/4	1-1/4	2	5/8	3/4
IL57-4G	IL57-4S	100	1/4-20	1/2	5/8	3	3/8	3/16
IL57-5G	IL57-5S	500	5/16-18	1/2	5/8	3	3/8	3/16
IL57-6G	IL57-6S	1000	3/8-16	1/2	5/8	3	3/8	3/16
IL57-7G	IL57-7S	2000	1/2-13	5/8	15/16	3	3/8	1/2
IL57-8G	IL57-8S	3000	5/8-11	3/4	1-1/8	3	1/2	5/8
IL57-9G	IL57-9S	3000	3/4-10	1	1-3/16	3	9/16	11/16
IL57-10G	IL57-10S	3000	1-8	1-1/4	1-1/4	3	5/8	3/4
IL59-4G	IL59-4S	100	1/4-20	1/2	5/8	4	3/8	3/16
IL59-5G	IL59-5S	500	5/16-18	1/2	5/8	4	3/8	3/16
IL59-6G	IL59-6S	1000	3/8-16	1/2	5/8	4	3/8	3/16
IL59-7G	IL59-7S	2000	1/2-13	5/8	15/16	4	3/8	1/2
IL59-8G	IL59-8S	3000	5/8-11	3/4	1-1/8	4	1/2	5/8
IL59-9G	IL59-9S	3000	3/4-10	1	1-3/16	4	9/16	11/16
IL59-10G	IL59-10S	3000	1-8	1-1/4	1-1/4	4	5/8	3/4



MEDIUM-DUTY LEVELERS
POLY SWIVEL
LP METRIC SOCKET

LOW PROFILE METRIC POLY SWIVEL SOCKET LEVELERS

The IEC Poly Base Steel and Stainless Steel Swivel Socket Leveler is ideal for medium-duty load requirements. Nylon bases 1" to 4" with 15 degree swivel from centerline. Steel Socket has trivalent zinc, yellow chromate finish.

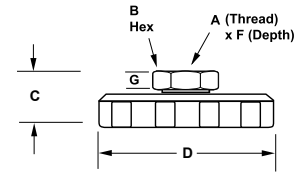

Features

- Corrosion resistant
- 15 degree swivel
- 5 base diameters
- Glass-filled nylon
- Loads to 3,000 lbs.
- RoHS compliant

Applications

- Electronic equipment
- Enclosures
- Conveyors
- Machinery
- Work tables
- Display racks



Nut Height: "G" = 1/2", 5/8", 11/16", 3/4"
for Threads: M12, M16, M20, M24

Nut Height: "G" = 3/16"
for Threads: M6, M8, M10

LOW PROFILE METRIC POLY SWIVEL — SOCKET LEVELERS

Steel	Stainless	Load	A	B	C	D	F	G
IL51-M6G	IL51-M6S	100	M6X1	1/2	5/8	1	3/8	3/16
IL51-M8G	IL51-M8S	500	M8X1.25	1/2	5/8	1	3/8	3/16
IL51-M10G	IL51-M10S	1000	M10X1.50	1/2	5/8	1	3/8	3/16
IL51-M12G	IL51-M12S	2000	M12X1.75	5/8	15/16	1	3/8	1/2
IL51-M16G	IL51-M16S	3000	M16X2.00	3/4	1-1/8	1	1/2	5/8
IL51-M20G	IL51-M20S	3000	M20X2.50	1	1-3/16	1	9/16	11/16
IL51-M24G	IL51-M24S	3000	M24X3.00	1-1/4	1-1/4	1	5/8	3/4
IL53-M6G	IL53-M6S	100	M6X1	1/2	5/8	1 1/2	3/8	3/16
IL53-M8G	IL53-M8S	500	M8X1.25	1/2	5/8	1 1/2	3/8	3/16
IL53-M10G	IL53-M10S	1000	M10X1.50	1/2	5/8	1 1/2	3/8	3/16
IL53-M12G	IL53-M12S	2000	M12X1.75	5/8	15/16	1 1/2	3/8	1/2
IL53-M16G	IL53-M16S	3000	M16X2.00	3/4	1-1/8	1 1/2	1/2	5/8
IL53-M20G	IL53-M20S	3000	M20X2.50	1	1-3/16	1 1/2	9/16	11/16
IL53-M24G	IL53-M24S	3000	M24X3.00	1-1/4	1-1/4	1 1/2	5/8	3/4
IL55-M6G	IL55-M6S	100	M6X1	1/2	5/8	2	3/8	3/16
IL55-M8G	IL55-M8S	500	M8X1.25	1/2	5/8	2	3/8	3/16
IL55-M10G	IL55-M10S	1000	M10X1.50	1/2	5/8	2	3/8	3/16
IL55-M12G	IL55-M12S	2000	M12X1.75	5/8	15/16	2	3/8	1/2
IL55-M16G	IL55-M16S	3000	M16X2.00	3/4	1-1/8	2	1/2	5/8
IL55-M20G	IL55-M20S	3000	M20X2.50	1	1-3/16	2	9/16	11/16
IL55-M24G	IL55-M24S	3000	M24X3.00	1-1/4	1-1/4	2	5/8	3/4
IL57-M6G	IL57-M6S	100	M6X1	1/2	5/8	3	3/8	3/16
IL57-M8G	IL57-M8S	500	M8X1.25	1/2	5/8	3	3/8	3/16
IL57-M10G	IL57-M10S	1000	M10X1.50	1/2	5/8	3	3/8	3/16
IL57-M12G	IL57-M12S	2000	M12X1.75	5/8	15/16	3	3/8	1/2
IL57-M16G	IL57-M16S	3000	M16X2.00	3/4	1-1/8	3	1/2	5/8
IL57-M20G	IL57-M20S	3000	M20X2.50	1	1-3/16	3	9/16	11/16
IL57-M24G	IL57-M24S	3000	M24X3.00	1-1/4	1-1/4	3	5/8	3/4
IL59-M6G	IL59-M6S	100	M6X1	1/2	5/8	4	3/8	3/16
IL59-M8G	IL59-M8S	500	M8X1.25	1/2	5/8	4	3/8	3/16
IL59-M10G	IL59-M10S	1000	M10X1.50	1/2	5/8	4	3/8	3/16
IL59-M12G	IL59-M12S	2000	M12X1.75	5/8	15/16	4	3/8	1/2
IL59-M16G	IL59-M16S	3000	M16X2.00	3/4	1-1/8	4	1/2	5/8
IL59-M20G	IL59-M20S	3000	M20X2.50	1	1-3/16	4	9/16	11/16
IL59-M24G	IL59-M24S	3000	M24X3.00	1-1/4	1-1/4	4	5/8	3/4