



**INTERNATIONAL EQUIPMENT COMPONENTS, INC.**

Phone: 562.597.4533 eMail: sales@iec-corp.com

Web: www.equipmentknobs.com | www.iec-corp.com

KNOBS
ROUND BALL KNOBS
KNURLED KNOBS

**Round Ball Knobs**

These round phenolic ball knobs are offered in female thread with zinc plated steel insert and press-fit hole types.

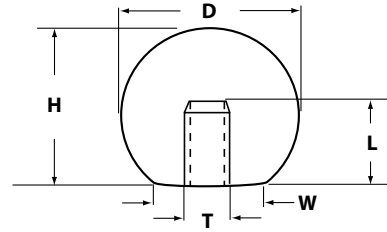

**ROUND PHENOLIC PHENOLIC BALL KNOBS**

P/N (female)	P/N (hole type)	Thread	D	H	Hole Depth	Press-Fit Stud
IL230F-3F		10-32	5/8	9/16		
IL231F-3	IL231H	10-24	3/4	11/16	1/2	13/16
IL232F-4		1/4-20	3/4	11/16		
IL233F-4	IL233H	1/4-20	1	7/8	5/8	1/4
IL234F-5		5/16-18	1	7/8		
IL235F-5	IL235H	5/16-18	1-1/4	1-3/16	9/16	5/16
IL236F-6	IL236H	3/8-16	1-1/2	1-7/16	3/4	3/8
IL237F-7	IL237H	1/2-13	1-3/4	1-11/16	13/16	1/2

**Knurled Knobs**

Phenolic knurled knobs are offered with a brass threaded insert, a zinc-plated steel stud or a stainless steel stud.

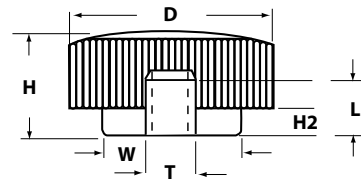

**PHENOLIC KNURLED KNOB WITH BRASS THREAD INSERT**

P/N	DIA.	Height	Width	H2	Thread	Length
IL420-3FX38	1	1/2	11/16	5/32	10-32	3/8
IL420-3X38	1	1/2	11/16	5/32	10-24	3/8
IL420-4X38	1	1/2	11/16	5/32	1/4-20	3/8
IL420-5X38	1	9/16	5/8	5/16	5/16-18	3/8
IL420A-4X44	1-3/8	3/4	3/4	3/8	1/4-20	7/16
IL420A-5X44	1-3/8	3/4	3/4	3/8	5/16-18	7/16
IL420B-5X44	1-7/8	1	1	1/2	5/16-18	7/16
IL420B-6X50	1-7/8	1	1	1/2	3/8-16	1/2



**Knurled Knobs**

Phenolic knurled knobs are offered with a brass threaded insert, a zinc-plated steel stud or a stainless steel stud.

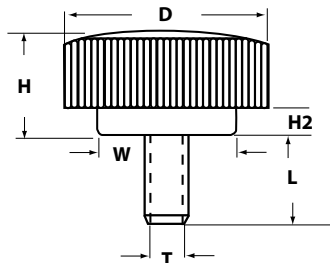

**PHENOLIC KNURLED KNOB WITH ZINC PLATED STEEL STUD**

P/N	DIA.	Height	Width	H2	Thread	Length
IL421-1X75	1	13/32	1/2	0	6-32	3/4
IL421-4x75	1	13/32	1/2	0	1/4-20	3/4
IL421-3FX50	1	21/32	5/8	5/16	10-32	1/2
IL421-4X50	1	1/2	11/16	5/32	1/4-20	1/2
IL421-4X1	1	1/2	11/16	5/32	1/4-20	1
IL421A-4X50	1-3/8	25/32	3/4	3/8	1/4-20	1/2
IL421A-4X125	1-3/8	25/32	3/4	3/8	1/4-20	1-1/4
IL421A-5X75	1-3/8	25/32	3/4	3/8	5/16-18	3/4
IL421A-5X150	1-3/8	25/32	3/4	3/8	5/16-18	1-1/2
IL421B-6X1	1-7/8	3/4	1	1/4	3/8-16	1
IL421B-5X1	1-7/8	1	1	1/2	5/16-18	1
IL421B-5X2	1-7/8	1	1	1/2	5/16-18	2
IL421B-6x1	1-7/8	1	1	1/2	3/8-16	1
IL421B-6x2	1-7/8	1	1	1/2	3/8-16	2

**PHENOLIC KNURLED KNOB WITH 303 STAINLESS STEEL STUD**

P/N	DIA.	Height	Width	H2	Thread	Length
IL421-3FX50-SS	1	21/32	5/8	5/16	10-32	1/2
IL421-3FX1-SS	1	21/32	5/8	5/16	10-32	1
IL421-4X50-SS	1	21/32	5/8	5/16	1/4-20	1/2
IL421-4X1-SS	1	21/32	5/8	5/16	1/4-20	1
IL421-4X150-SS	1	1/2	11/16	5/32	1/4-20	1-1/2
IL421-5X50-SS	1	1/2	11/16	5/32	5/16-18	1/2
IL421-5X1-SS	1	1/2	11/16	5/32	5/16-18	1
IL421A-3FX1-SS	1-3/4	11/16	1	7/16	10-32	1
IL421A-4X50-SS	1-3/8	25/32	3/4	3/8	1/4-20	1/2
IL421A-4X125-SS	1-3/8	25/32	3/4	3/8	1/4-20	1-1/4
IL421A-5X75-SS	1-3/8	25/32	3/4	3/8	5/16-18	3/4
IL421A-5X150-SS	1-3/8	25/32	3/4	3/8	5/16-18	1-1/2
IL421A-5X50-SS	1-3/4	11/16	1	7/16	5/16-18	1/2
IL421A-5X75-SS	1-3/4	11/16	1	7/16	5/16-18	3/4
IL421A-5X1-SS	1-3/4	11/16	1	7/16	5/16-18	1
IL421B-5X1-SS	1-7/8	1	1	1/2	5/16-18	1
IL421B-5X2-SS	1-7/8	1	1	1/2	5/16-18	2
IL421B-6x1-SS	1-7/8	1	1	1/2	3/8-16	1
IL421B-6x2-SS	1-7/8	1	1	1/2	3/8-16	2